

Dear exhibitors and business partners,

Incheba a.s. is not only the organiser of exhibitions and fairs, but it can also offer you a full service. We offer the construction of exhibitions with supplementary services for a quality presentation of your firm.

We guarantee to our clients quality and a professional approach as a result of long-term experience in the field of exhibitions and fairs not only in the Slovak market but also abroad.

We offer the construction of exhibitions from classical and modern construction and decoration systems. For demanding clientele we can prepare exhibitions with atypical design using unique materials and elements, made-to-measure for the client. Our objective is that the constructions of exhibitions designed by our architects respect the particularity of the firm and fulfil at the same time the main attributes which are the functionality and effectiveness of the presentations with regard to individual requirements. In the case of limited financial resources we offer the possibility of elegant and effective compromise, the combination of classical construction systems and atypical elements.

This manual will help you in the construction of your requirements.

We wish you many business achievements and a pleasant time spent at Bratislava fair.

Your construction team

TABLE OF CONTENTS

CONDITIONS AND REGULATIONS	1.1	GENERAL CONDITIONS OF PARTICIPATION
	1.2	ELECTRIC POWER SUPPLY
CONSTRUCTION OF EXHIBITIONS	2.1	INTERIOR – EXTERIOR
	2.2	TYPE ELEMENTS
	2.3	FLOOR, OTHER
	2.4	SCHEME
FURNITURE AND EQUIPMENT	3.1	FURNITURE
	3.2	SMALL EQUIPMENT
	3.3	FLOWERS
AUDIOVISUAL TECHNIQUE	4.1	AUDIOVISUAL TECHNIQUE
TECHNICAL SUPPLIES	5.1	ELECTRICITY, WATER, COMPRESSED AIR
TELECOMMUNICATION SERVICES	6.1	TELEPHONE LINES, ISDN, INTERNET
SERVICES	7.1	CLEANING, GUARDING, HOSTESSES, INTERPRETER
	7.2	PASSES, INVITATIONS, CATALOGUE
	7.3	HANDLING, FORWARDING, LOGISTICS
	7.4	LEASE OF CONFERENCE PREMISES
	7.5	REPORTING OF A CO-EXHIBITOR
	7.6	REPORTING OF CONSTRUCTION FIRMS
PICTURE GALLERY	8.1 - 8.5	CONSTRUCTION OF EXHIBITIONS
	8.6 - 8.8	FURNITURE AND EQUIPMENT



CONDITIONS AND REGULATIONS

GENERAL CONDITIONS OF PARTICIPATION

Paragraph I. THE ORGANIZER
INCHEBA, Public Company, Viedenská cesta 3-7, 851 01 Bratislava 5, the Slovak Republic ("Organizer")

Paragraph II. THE EXHIBITOR
Under Exhibitor we understand a subject submitting a binding application form, which has to be sent to the address of the organizer, and upon which the organizer will confirm its reception by sending an invoice including the registration fee and rented space fee.

Paragraph III. PARTICIPATION APPLICATION AND SPACE ASSIGNMENT

1. Incheba determines the topic and focus of the exhibition.
2. It is possible to register for the exhibition only and exclusively by written application and the acceptance of these General Terms.
3. Application form sent to the organizer is for the exhibitor obligatory, even if the organizer cannot fulfill all requirements stated by the applicant, e.g. type and extent.
4. Incheba rents and assigns the exhibition space, while taking into consideration the requirements of the exhibitors.
5. Organizer reserves the right to refuse any participation application.
6. The exhibitor is not entitled to sub-lease the space to a third party.
7. Payment of the rent for the space and all ordered services is the condition for taking over the space. Exhibitors whose exposition is not provided by the organizer will have to deposit a financial amount as guarantee in accordance to the size of rented space and provision of mounting permit for each person of the mounting team. The deposit may vary in range of 5 – 10 thousand SKK and is stated by the organizer in organising conditions.
8. If the exhibitor does not accept the assigned and paid area, at the latest by 12:00 o'clock the day before the opening of the exhibition, the organizer is allowed to do as he or she feels fit. The exhibitor does not have any right for the refunding of fees paid and any other financial compensation.

Paragraph IV. REGISTRATION FEE, SPACE AND SERVICES RENTAL

1. The exhibitor is obliged to reimburse the registration fee, rent for booked space and all services. By not fulfilling this condition gives the organizer the right to avoid the contract.
2. The rental fee for indoor and outdoor space is contained in the obligatory application. Each started sqm is counted as a full sqm.
3. The smallest space assignment is six sqm, however Incheba may grant exceptions.
4. In case of ordering (purchasing) of selected services (furniture, small equipment, carpets, etc.) in the exposition areas that have not been realised by the organizer, the exhibitor is entitled to charge a price with a 100% surcharge.
5. Services that have been ordered (purchased) after the deadline date stated by the organizer for given exhibition will be charged up to 100% of the surcharge. The organizer reserves the right to decline (reject) such an offer.
6. The exhibitor is obliged to reimburse the co-exhibitor fee for each company physically represented in its exhibition stand.

Paragraph V. PAYMENT CONDITIONS

1. After peramancy of the application form from the exhibitor the organizer will send an advance invoice including the registration fee and exhibition space rental in the full amount.
2. The exhibitor is committed to reimburse to the organizer all ordered services to the due date stated in the invoice. If the exhibitor will not reimburse the invoice to the due date, the contracting parties agree to charge a penalty of 0.05% for each delayed day. In case of late payment, the exhibitor is obliged to reimburse costs related to legal support, judicial and extra-judicial costs for recovery, wherefore extra-judicial costs will be 25% of amount owing, minimally 10,000,- SKK. In case of a payment reimbursed after the due date there is an interest fee stated by the law. Reimbursement of contractual penalty will not acquit the duty (discharge of an obligation) of the exhibitor related to infliction of damage.
3. Additional service orders, purchased 7 days before the official opening of exhibition, will be realised only upon antecedent payment (settlement). All complaints of exhibitors regarding payments to the organizer will have to be claimed in writing 14 days after receiving the invoice. Complaints received after this time period will be acknowledged.
4. If an exhibitor fails to meet all of its exhibition related obligations towards organizer, organizer may hold the exhibits of such exhibitor located in the exhibition hall, or have them stored at the cost and responsibility of the exhibitor, so that the failed obligations may be fulfilled without a court claim. Organizer is entitled to arrange for the public or private sale of such exhibits 30 days after the exhibition closure if an exhibitor fails to fulfill its obligations. Incheba is obliged after such sale to submit details and difference in the statement of costs between the sale in come and its outstanding debts plus storage and sale costs.
5. Cancellation of exhibitor's participation at the exhibition will be charged as follows:
The penalty for cancellation more than 60 days before the event, represents 50% from the rented space + registration fee.
The penalty for cancellation between 30 to 60 days before the event, represents 75% from the rented space + registration fee.
The penalty for cancellation 30 days before the event, represents 100% from the rented space + registration fee.
Fee for cancellation of ordered services after the closing deadline, represent 50% from the amount of ordered services.
6. Cancelling the participation must always be realised in a written form and must be properly delivered to the organizer. If the exhibitor will not cancel its participation by the above-mentioned procedure, he or she must meet all costs related to prejudice caused by its aloofness including the cancellation fee.
7. The commitment to reimburse the cancellation fee arises even if from the exhibitor party did not come to the reimbursement of rented space and the registration fee before cancelling its participation.
8. If an exhibitor declares bankruptcy before or during the exhibition, and it applies for a compensation proceeding, or enters liquidation, this agreement immediately loses its validity without any demonstration of will on the part of Incheba. Furthermore, organizer is entitled to keep the paid rent and its outstanding claim remains without any right to compensation.
9. If the exhibition does not take place, all the applications and space assignments shall be considered cancelled, and all payments after the deduction of costs related to the setting up of the exhibition shall be refunded to the exhibitors. These costs may be partially or entirely distributed among exhibitors in the maximum amount of 15 % of the original rent of the exhibition space. This sum shall be refunded within 90 days from the date of the exhibition's cancellation.

Paragraph VI. THE EXHIBITS

1. The exhibits and offered services must comply with the exhibition orientation. The exhibitor has no right to present different exhibits or to offer different services. The maximal weight of single exhibits is 300kg/sqm. Exhibitors must receive a written conformation from the organizer in case of exhibits of higher weight.
2. Goods without a previous written conformation from the organizer are not permitted to be sold at the exhibition. (It does not involve sales events thus directly specified by the organizer.) Import and export of exhibits is governed by organisational conditions. Acceptance of exhibition space, stand or goods is always performed by the exhibitor, eventually its accredited assistant manager. In case that the exhibitor or its accredited assistant manager will not be present at the spot, the exhibit will be unloaded at the assigned exhibition place at exhibitor's own risk.
3. Moving and storage fees according to the price list of the contracted shipper shall be charged for exhibits and installation material, which will not be removed by the date of dismantling.
4. Organizer determines the time, by which the removal of exhibition stands and exhibits must be completed. Exhibits remaining after this deadline shall be removed and stored at the cost and responsibility of the pertinent exhibitor.

Organizer is entitled to conduct a public or private sale, if exhibits are not collected within 30 days, provided it submits an accounting statement with deductions for expenses. Organizer is expressly entitled to take such action towards the exhibitor.

Paragraph VII. CUSTOMS AND SHIPPING SERVICES

1. Customs and shipping services have to be ordered in a written form at the exclusive forwarding agent of the organizer. The contact information on the exclusive forwarding agent is listed in the Organisational conditions of particular exhibition.

Paragraph VIII. CONSTRUCTION AND INSTALLATION OF STANDS, MOUNTING OF EXHIBITS, TECHNICAL PROVISIONS AND REGULATIONS

1. Organisational conditions of the event will be provided to the exhibitor by the organizer in advance before the beginning of installation. These conditions represent a non-detachable constituent of General conditions and are obligatory for the exhibitor.
2. Organizer determines the setting up and dismantling dates. Exceptions to the dates are permitted for a fee according to the price list.
3. The organizer determines at what conditions and to whom it will be, respectively to whom it won't be enabled entry into the premises in order to install/disassemble. The time schedule of installation and disassembly of the exhibition determined by the organizer represents a constituent of the catalogue of services and it is strictly recommended to follow these conditions. Prolongation of installation activities after assembly hours is allowed only upon written approval of the organizer, which has to be contacted minimally 2 hours before the end of the official time of assembly. The prolongation is permitted for a consideration. In the last day of installation, before the grand opening of the exhibition event it is not possible to prolong the assembling hours.
4. The regulations and organizational instructions related to setting up, dismantling and the course of the given exhibition are presented in the Participation Terms, which Incheba shall provide for the exhibitor or a person authorized by him/her sufficiently prior to the exhibition opening. The exhibitor is obliged to abide by the Participation Terms, the instructions for the application materials, the safety and fire regulations and the pertinent legal norms valid on the territory of the Slovak Republic. Exhibitors are obliged to inform all internal as well as external workers about above-mentioned responsibilities.
5. The exhibitor is obliged to follow instructions issued by organizer or by the fire department related to the construction, decoration, safety, maintenance and removal of its stand, promotional materials located in the stand, exhibits and items and the use of decorations. If these terms are violated, the exhibitor shall authorize Incheba to close the exhibition stand without further responsibility for any consequences caused by such action, and will not be entitled to claim any payments.
6. Outside exhibition facilitators are obliged to purchase set up passes and present business licenses authorizing the holder for such activity, or the excerpt from the Commercial Register specifying the scope of activities according to which, it is authorized to carry out such activity and contractual insurance of liabilities for damages caused by own operation within the paragraph XIII article 3.
7. Exhibition halls serve during the installation only for assembling purposes, not for the production of exposures. The approval for the production activities has to be submitted to the organizer in a written form. These activities have to be performed in designated areas after reimbursing stated price amount. The exhibitor is obliged to assure a clean environment during the realization of its exposure by managing its own work as well as work of its suppliers and using all available technical facilities in order to keep the working area clean. Hanging structures of the exposure have to be approved by the organizer in a written form. Realization of such structures is performed exclusively through the organizer according to the valid tariff and after its reimbursement.
8. After assigning the exhibition area the exhibitor is obliged to provide a plan of the stand in two hard copies, or a model accompanied by a simple drawing design in an equivalent scale according to the Organisational conditions no later than 1 month before the date of installation. If the exhibitor will not adhere given term the organizer has right to invoice this service amounting to 5000,- SKK for express processing of documents and endorsement of project documentation. At the same time the organizer reserves a right to reject the participation.
9. Imported material will be endorsed at the entry by employee of security service. Conveyance of the assembly material will be realised through a designated gate during agreed time needed to unload the material. Upon exhibitors request it is also possible to open a gate near by its exhibition area – exhibition service team will provide this service for a provision.
10. Intervention into the exhibition hall or free spaces is not permitted. Potential arrangement requested by the exhibitor will be provided exclusively by the organizer for a provision and right to reject this request from organizer's side. Violation of this instruction can lead to exhibitor's recall of participation without any refund.
11. The exhibitor/performer is obliged in case of its own assembly/disassembly to remove all material/whole exposure. In case of a higher volume of waste is the exhibitor obliged to order a high-density container at the organizer.
12. Maximal allowed height of the exposure including the frame is 3m – tolerances are allowed by the organizer for a certain provision. Interference of the frame or eye-catcher into the communication (way) is permitted only upon an approval of the organizer under assumption that the minimal height of lower edge is 2.5m and provision paid is 2000,- SKK. The price for an elevated dominant of ground-plan area up to 4sqm is 5000,- SKK. The price stated for height of the stand of more than 3m and more than 4sqm ground-plan area represents 10% from the price of grossed area, which is at least 10,000,- SKK. For typical two-floor exposures it is required to provide a structural static analysis regarding also gust wind.
13. It is inadmissible to provide media to other subjects, otherwise it will be disconnected. In case of overcoming of ordered input power of electricity, it will not be possible to connect again without a previous gross up of input power and cash payment. Increased costs incurred by locating the input further than 10m from the technical channel will be individually charged. Before laying down the carpet all realization companies must use a masking paper tape and consequently double-sided tape. (The masking tape can be purchased at the exhibition service centre.)
14. Entry with motor vehicles, sidecars and other paddle (wheel) mechanisms into the exhibition halls is strictly prohibited. In special cases only the hall administrator can give the exception. In case of exhibiting motor vehicles they must have an empty tank and disconnected battery.
15. The exhibitor is obliged to start construction and removal of its exhibition stand so that this work shall be completed within the time limits stipulated by the Participation Terms.
16. The exhibitor is not allowed to remove exhibits and stands prior to the end of the exhibition. In the event of any violation of this regulation, the exhibitor irrevocably agrees to pay 20,000,- SKK.
17. When leaving a rented exhibition stand and exhibition space, the exhibitor is obliged to restore them to their original status and to return undamaged, all movables rented from Incheba. If Organizer considers it necessary to take additional steps to restore the stand, space or installations to its original status, the costs of such steps shall be charged to the pertinent exhibitor.
18. In case of violation of deadline term for clearing and leaving the exhibition area the organizer has the right to invoice a sanction up to 1000,- SKK/sqm of non-removed space. All additional costs arisen to the organizer will be in case of a late assembly/disassembly invoiced to the exhibitor.

Paragraph IX. PUBLICITY, ADVERTISING, TITLES, CATALOGUES, OTHER FORMS OF PROPAGANDA

1. The exhibitor is entitled to promote its products only and exclusively at its stand.
2. Any promotion and advertisement material may be located only and exclusively at the stand on the rented space. Posters, advertisement stickers and other promotional

items may be placed only at locations designated by organizer for such purpose and after payment of a fee, which is not part of the rent for the stand space. Placing billboards, eye-catchers, streamers, as well as hand out of leaflets is allowed only upon a written approval of the organizer according to the valid price list.

3. A catalogue is issued for individual exhibitions. Each exhibitor is obliged to have its company name, full address and telephone and fax number publicized within the catalogue for free. Organizer is not liable for any incorrect data presented in the "Catalogue" form, for data submitted after the deadline, as well as for possible mistakes in the abovementioned data. The exhibitor must provide Organizer with the data for the catalogue on the pre-printed "Catalogue" form. The organizer does not guarantee publication of text supplied after the deadline. Companies that are not exhibitors are only allowed to advertise in catalogs after written approval of the organizer is attained.
4. Using sound amplifying devices is not allowed, unless it has not been previously discussed and approved in written form by the organizer.
5. All modes of presentation within or outside one's own exhibition space (i.e. machines in operation, films, musical productions, fashion shows and so on) are subject to Incheba's approval. In spite of any prior approval, Incheba has the right to limit or cancel any show which causes noise, dust, exhaust fumes, vibrations, or for other reasons which obstruct or disrupt the fair. Repeated violation of this provision will cause prohibition of particular activity of the exhibitor. Audio advertisements, reproduced recordings, etc may only be used according to organizer's approval. The noise level beyond the stand limits may not exceed 65dB. If this noise level is exceeded, the exhibitor shall be notified. If the noise level is not reduced, the exposition's electricity shall be disconnected and the exhibitor irrevocably agrees to pay a fine of 50,000,- SKK.
6. In the event of the use of reproduced music at the exhibition stand, the obligations relating to the Authors Act and the responsibility to pay, in full, the royalties to the legal entities exercising collective control of the rights pursuant to the Authors Act are assumed and borne by the exhibitor.
7. The organizer has the right to prohibit any advertising that does not follow above-mentioned provision and at the same time charge the exhibitor for its removal.

Paragraph X. RULES VALID DURING EXHIBITION

1. The organizer has the right to change the date and operation time of the exhibition without any reimbursement from the exhibitor's side. The contract of participation persists in its validity.
2. The organizer determines at what conditions and to whom it will be, respectively to whom it won't be enabled entry into the premises.
3. In the range required in the order the exhibitor will obtain for each team member identification cards allowing a free entry into the exhibition premises and exhibition stand during a given date and time. Exhibitor's ID is valid only for one person.
4. The exhibitor is responsible for the consequences of his/her actions or the actions of those who are acting directly or indirectly as his/her representatives.
5. The exhibitor or his/her representative is obliged to be personally present at his/her exhibition stand and to allow access to the stand to visitors during the exhibition opening hours.
6. The exhibitor is fully entitled to deny access to the stand to particular persons. The authorized employees of Incheba always have access rights to the stand.
7. The exhibitor has no right to use flammable or highly combustible materials, open fires, furnaces or ovens at the rented stand, without having previously negotiated it with Incheba and without a written agreement. Valid fire regulations must be followed.
8. Serving beverages is only permitted as long as it does not violate the regulations of providing catering services at the pertinent exhibition space.

Paragraph XI. CLEANING UP

1. Incheba is responsible for the maintenance and cleaning of the exhibition area, halls and sidewalks. The cleaning up of a stand prior to opening must be finished within the setting up time limits. During the course of the exhibition, the exhibitor may only order exhibition stand clean up services only through organizer.

Paragraph XII. SECURITY

1. Organizer provides for the general security of the exhibition area during the course of the setup, dismantling and during the exhibition itself. The general security provided by Incheba does not rule out the possibility of personal or property damage. An exhibitor may only order individual security services for its property or exposition through organizer.
2. Obtaining an order for guarding exposition for less than 7 days before the grand opening, the organizer has the right to charge a provision amounting 50%.

Paragraph XIII. INSURANCE – LOSS

1. The exhibitor participates in the exhibition completely at its own risk. The exhibitor shall not hold Incheba responsible for any claims of third parties for damages caused as a result of its participation at the exhibition.
2. Organizer is not liable to the exhibitor, co-exhibitor and outside exhibition facilitators for losses, destruction or any damage to exhibits, accessories or equipment at the stand, or for any packing and wrapping material regardless of whether the destruction or other damage takes place before, during or after the exhibition.
3. Organizer requires that exhibitors and outside facilitators obtain insurance, at their own costs, to cover for damage caused by their own activities, to the extent in accordance with the following table:
 - exhibitors constructing expositions on their own, 15,000 EUR
 - implementing companies that implement the exposition up to 20sqm - 30,000 EUR
 - implementing companies that implement the exposition up to 50sqm - 60,000 EUR
 - implementing companies that implement the exposition up to 100sqm - 90,000 EUR
 - implementing companies that implement the exposition up to 200sqm - 120,000 EUR
 - implementing companies that implement the exposition up to 300sqm - 150,000 EUR
 - implementing companies that implement the exposition up to 400sqm - 180,000 EUR
 - implementing companies that implement the exposition up to 500sqm - 210,000 EUR
 - implementing companies that implement the exposition up to 600sqm - 240,000 EUR
 - implementing companies that implement the exposition up to 700sqm - 270,000 EUR
 - implementing companies that implement the exposition over 700sqm - 300,000 EUR
4. If the exhibitor fails to fulfill this condition and fails to enter into an insurance policy, or is not able to prove such circumstance, Incheba shall be authorized to ban such exhibitor from entering the premises until the situation is remedied.
4. Exhibitors, who do not order implementation of their exposition through organizer (or other implementation firms) are obliged to prove at the registration that they have insurance (starting from the set up of the exhibition through its dismantling) covering liability for damages caused by their own activities.

Paragraph XIV. CLOSING PROVISIONS

1. If the organizer cannot realise the exhibition or ensure its operation for the whole period of duration due to inevitable circumstances ("force majeure"), he shall inform the exhibitors of this fact. All obligations arising for the organizer from the concluded contract shall thus terminate. It shall not give rise to any claim for compensation for the exhibitor.
2. In case of breach of the provisions of the General conditions the organizer is entitled to exclude the exhibitor from participation in the exhibition not giving rise to any claim for reimbursement of payments.
3. The exhibitor may claim reclamation for works and services provided by the organizer with a responsible employee without undue delay and in written form, within 48 hours before termination of the event at the latest. Otherwise his right expires.
4. In cases not governed by these conditions the exhibitor shall conform to the instructions of the organizer.
5. Relations and arguments between the exhibitor and the organizer will be resolved within the meaning of the provisions of Commercial code No. 513/1991 Coll. as amended.

I AGREE WITH THE TEXT OF THE GENERAL CONDITIONS OF PARTICIPATION

PLACE / DATE / STAMP / SIGNATURE



INCHEBA
EXPO BRATISLAVA

WARNING:

1. INCHEBA, a.s. Bratislava reserves the right to refuse the realisation of an order without a filled-in form 2.4.
2. A ground-plan drawing of the stand with the marking of supply spots shall be an integral part of the order. Use a separate form 2.4 and after completing the information send it via fax to the fax number 6727 2011
3. Supply to 2 kW – it is a single-phase connection 230 V (10A) terminated by a single socket 230 V serving only for the connection of one consumer. In case of a repeated failure of protection it will not be possible to put the electric installation into operation without increasing the input power.
4. The total input power means the input power of all consumers connected to the connection in accordance with the project documentation.
5. The order has to be delivered to the commercial guarantee ensuring the realisation of the exposition and the service, including the project (see Conditions for connections and electric power supply).
Dates and the increase of price for late order of services are stated in the Organisational instructions of individual events.
6. The payment for ordered services has to be made to INCHEBA, a.s. Bratislava (charged on account) according to the disposition on the sent invoices, always until the opening of the event at the latest.
7. The exhibitor is bound to entrust the realisation of the electro-installation of the stand only to a professional firm with authorisation according to regulation 718/2002 Coll. and the Trade license.
8. It is inadmissible to supply electricity or other energy media to other subjects within the meaning of valid legal regulations. Non compliance with this principle may lead to recourse – disconnection of electricity or the corresponding energy medium without compensation.
9. The charge for cancellation of the order of an already installed electro supply (3 days before the opening of the event at minimum) is 100% of the invoice amount.

CONDITIONS OF CONNECTION AND SUPPLY OF ELECTRIC ENERGY:

1. The order shall be delivered together with an electro-project of the stand three weeks before the opening of the exhibition at the latest. For the designation of the connection spot in the stand disposition the form 2.4 has to be used, as stated on the order sheet. For orders submitted after the specified deadline, warranty and safety of the construction of the connection within the specified deadline cannot be guaranteed.
2. The connection 230 / 400 V is terminated by a 3 f socket CEE 3 + A + PE (32A or 63A, five sockets)
The distributor of the exposition is connected by the firm carrying out the electric installation of the stand. An independent connection of the exhibit with an individual connection may be ordered. By default connections for the take-off up to 40 kW can be realised (63A at maximum). Switching the power supply on and off (operation of expositions) is defined in the Organisational instructions of the event.
3. The refrigerators have an independent (permanent) connection terminated by a 1f socket 230V secured by a safety switch 2A.
4. Connections of higher input powers as well as special requirements for supply shall be specified early and in advance.
5. The connections are realised exclusively by INCHEBA, a.s. Bratislava. The connections are rented in the form of lease.
6. The assembly of the interior electrical installation of the exposition may be realised by:
 - a) INCHEBA, a.s. Bratislava
 - b) The staff of the firm or a third party under the following conditions:
The exhibitor has full responsibility for the construction of and the state of the interior electrical installation. Installation works have to be realised in accordance with electro-technical regulations and provisions of rules in force in SR – STN 33 2000 – 7 – 711 and the “Directive for the construction and operation of temporary electrical installations” in the premises of INCHEBA, a.s. Bratislava. The capacity of the electrical installations and articles produced according to other regulations, for example DIN, VDE, EN, ICE is decided by the inspection technician within the framework of the realisation of the initial inspection (Expert inspection and expert testing of the electrical equipment).
The assembly of the interior electrical installation of the exposition may only be realised by a professional firm with certificate and trade license for the assembly of electrical installations in a supply method.
The exhibitor assumes full responsibility for damages that may be incurred on the objects of INCHEBA, a.s. Bratislava, expositions and exhibits of co-exhibitors by a defective or insufficient electrical installation realised by the exhibitor.
7. The exhibited exhibits and other electrical equipment connected to the electric network shall have valid inspection reports or certificates of quality and similar. The exhibitor is fully responsible for their safe operation and possible damages caused by the operation of these equipment.
8. The electrical installation shall be inspected before putting it into operation (under power) by an inspection technician authorised by INCHEBA, a.s. Bratislava for its compliance with the above mentioned regulations. Detected defects must be removed immediately. In case of significant breach of the valid mentioned regulations the electrical installations will not be connected and/or the supply in an already operated installation will be disconnected.
In such cases there is no backward compensation for the realisation of the supply and the installation.
Costs for the realisation of the main supply will be accounted for in any case.
9. The electric current is supplied to the realised and inspected equipment already during two days before the opening of the exhibition.

I AGREE WITH THE TEXT OF THE GENERAL CONDITIONS OF PARTICIPATION

PLACE / DATE / STAMP / SIGNATURE

INCHEBA
EXPO BRATISLAVA

CONSTRUCTION OF EXPOSITIONS

INTERIOR - EXTERIOR

SEND THE FILLED-IN FORM VIA MAIL TO THE FOLLOWING ADDRESS:
INCHEBA, A.S. VIEDENSKÁ CESTA 3-7, 851 01 BRATISLAVA,
OR VIA FAX STATED ON THE REGISTRATION FORM

FIRM	EXHIBITION / FAIR	HALL
<input type="text"/>		
NAME OF THE RESPONSIBLE PERSON	TELEPHONE / EMAIL	
<input type="text"/>		

TYPE CONSTRUCTIONS – INTERIOR

	Type	Dimension	Area	Price in EUR without VAT	
SPACE VISUALISATIONS ON PAGE 8.1 – 8.2 THE PRICE OF THE STAND INCLUDES A. CARPET B. EXTERNAL WALLS OF WHITE PANELS C. CEILING RASTER D. STORAGE WITH LOCKABLE DOOR AND A SHELF (P) E. ELECTRIC OUTLET, SPOT LIGHTS (1 PC / 3M2), ROOF LIGHTS F. WHITE BORDER, LENGTH ACCORDING TO THE DIMENSION OF THE STAND, DESK (0/1) G. TABLE, CHAIRS, WASTE BASKET, HANGER	<input type="checkbox"/>	1.	2 x 3 m	6 sqm	225,-
	<input type="checkbox"/>	2.	2 x 3 m	6 sqm	225,-
	<input type="checkbox"/>	3.	3 x 3 m	9 sqm	338,-
	<input type="checkbox"/>	4.	3 x 4 m	12 sqm	454,-
	<input type="checkbox"/>	5.	3 x 5 m	15 sqm	563,-
	<input type="checkbox"/>	6.	3 x 6 m	18 sqm	672,-
	<input type="checkbox"/>	7.	4 x 4 m	16 sqm	597,-
	<input type="checkbox"/>	8.	4 x 5 m	20 sqm	747,-
	<input type="checkbox"/>	9.	4 x 6 m	24 sqm	897,-
	<input type="checkbox"/>	10.	5 x 5 m	25 sqm	938,-

TYPE CONSTRUCTIONS – EXTERIOR

	Type	Dimension	Area	Price in EUR without VAT	
SPACE VISUALISATIONS ON PAGE 8.1 – 8.2 THE PRICE OF THE STAND INCLUDES A. CARPET, CURTAINS, VEILINGS B. EXTERNAL WALLS OF WHITE OR GLASS PANELS C. ELECTRIC OUTLET, CEILING RASTER WITH SUSPENSION CIELINGS FILLINGS, LIGHTING AND ROOF E. KITCHEN UNIT WITH WATER SUPPLY AND WATER OUTLET, SHELF (P) F. WHITE BORDER, LENGTH ACCORDING TO THE DIMENSION OF THE STAND G. TABLE, CHAIRS, WASTE BASKET, HANGER	<input type="checkbox"/>	1.	4 x 4 m	16 sqm	1 235,-
	<input type="checkbox"/>	2.	6 x 4 m	24 sqm	1 832,-
	<input type="checkbox"/>	3.	8 x 4 m	32 sqm	2 322,-
	<input type="checkbox"/>	4.	8 x 4 m	32 sqm	2 322,-
	<input type="checkbox"/>	5.	9 x 4 m	36 sqm	2 479,-

ATYPICAL STAND

EXAMPLES OF ATYPICALLY DESIGNED CONSTRUCTIONS ON PAGE 8.3 We are interested in the elaboration of an initial project by the firm Incheba, a.s.

ATYPICAL STAND FROM TYPE ELEMENTS

EXAMPLES OF ATYPICALLY DESIGNED CONSTRUCTIONS BUILT FROM TYPE ELEMENTS ON PAGE 8.3	Type	Dimension	Area	THE PRICE WILL BE DETERMINED UPON AGREEMENT
	A	<input type="text"/> x <input type="text"/> m	<input type="text"/> m ²	

FLOOR STAND DPF

EXAMPLES OF DESIGNED CONSTRUCTIONS ON PAGE 8.3	Type	Dimension	Area	THE PRICE WILL BE DETERMINED UPON AGREEMENT
	A	<input type="text"/> x <input type="text"/> m	<input type="text"/> m ²	

PLACE / DATE / STAMP / SIGNATURE



INCHEBA
EXPO BRATISLAVA

CONSTRUCTION OF EXPOSITIONS

TYPE ELEMENTS

SEND THE FILLED-IN FORM VIA MAIL TO THE FOLLOWING ADDRESS:
INCHEBA, A.S. VIEDENSKÁ CESTA 3-7, 851 01 BRATISLAVA,
OR VIA FAX STATED ON THE REGISTRATION FORM

FIRM	EXHIBITION / FAIR	HALL
<input type="text"/>		
NAME OF THE RESPONSIBLE PERSON	TELEPHONE / EMAIL	
<input type="text"/>		

TYPE ELEMENTS (PAGE 8.4 - 8.5)

Designation

Requirement

Price in EUR without VAT

TYPE ELEMENTS	Designation	Requirement	Price in EUR without VAT	
SOLID WALL	A	990 x 2 500	<input type="text"/> pc 22,-	
	A / 1	700 x 2 500	<input type="text"/> pc 21,-	
	A / 2	1 400 x 2 500	<input type="text"/> pc 30,-	
	B	495 x 2 500	<input type="text"/> pc 18,-	
GLASS WALL	C	990 x 1 800	<input type="text"/> pc 29,-	
	C / 1	700 x 1800	<input type="text"/> pc 25,-	
	C / 2	990x 1 375	<input type="text"/> pc 27,-	
	C / 3	495 x 1 375	<input type="text"/> pc 24,-	
	C / 4	700 x 1375	<input type="text"/> pc 29,-	
	D	495 x 1 800	<input type="text"/> pc 22,-	
	DOOR	E	left	<input type="text"/> pc 29,-
		E	right	<input type="text"/> pc 29,-
E / 1		laminated	<input type="text"/> pc 29,-	
INCREASER	F	990 x 500 x 990	<input type="text"/> pc 29,-	
	G	990 x 500 x 495	<input type="text"/> pc 24,-	
	H	990 x 950 x 990	<input type="text"/> pc 35,-	
	H / 1	495 x 950 x 495	<input type="text"/> pc 24,-	
	H / 2	495 x 500 x 495	<input type="text"/> pc 16,-	
	I	990 x 950 x 495	<input type="text"/> pc 30,-	
	DESK	I / 1	990 x 950 x 495	<input type="text"/> pc 33,-
I / 2		990 x 1 125 x 495	<input type="text"/> pc 35,-	
I / 3		arch	<input type="text"/> pc 39,-	
WALL SHOW-CASE	J	990 x 1 800 x 990	<input type="text"/> pc 91,-	
	J / 1	990 x 1 375 x 990	<input type="text"/> pc 82,-	
	K	990 x 1 800 x 495	<input type="text"/> pc 75,-	
	K / 1	990 x 1 375 x 495	<input type="text"/> pc 69,-	
	K / 2	990 x 1 500 x 495	<input type="text"/> pc 60,-	
	K / 3	700 x 1 800 x 495	<input type="text"/> pc 82,-	
DESK SHOW-CASE	L	990 x 950 x 990	<input type="text"/> pc 44,-	
	M	990 x 950 x 495	<input type="text"/> pc 39,-	
	M / 1	990 x 495 x 495	<input type="text"/> pc 29,-	
SHELF	N	990 x 1 700 x 150	<input type="text"/> pc 17,-	
	O	990 x 2 500 x 350	<input type="text"/> pc 18,-	
	OŠ	990 x 2 500 x 300	<input type="text"/> pc 24,-	
	P	990 x 2 500 x 495	<input type="text"/> pc 38,-	
	P / 1	990 x 950 x 495	<input type="text"/> pc 16,-	
SIGN	R	950 x 250	<input type="text"/> pc 13,-	
CURTAIN	S	1 000 x 2 500	<input type="text"/> pc 7,-	
BORDER	V	1 000 x 400	<input type="text"/> pc 21,-	
CUBE	Z	950 x 950 x 950	<input type="text"/> pc 41,-	
ROLLER BLINDS	Y	1 000 x 2 500	<input type="text"/> pc 11,-	

PLACE / DATE / STAMP / SIGNATURE



INCHEBA
EXPO BRATISLAVA

CONSTRUCTION OF EXPOSITIONS

FLOOR, OTHER

SEND THE FILLED-IN FORM VIA MAIL TO THE FOLLOWING ADDRESS:
INCHEBA, A.S. VIEDENSKÁ CESTA 3-7, 851 01 BRATISLAVA,
OR VIA FAX STATED ON THE REGISTRATION FORM

FIRM	EXHIBITION / FAIR	HALL
<input type="text"/>		
NAME OF THE RESPONSIBLE PERSON	TELEPHONE / EMAIL	
<input type="text"/>		

FLOOR (PAGE 8.2)

Price in EUR without VAT

<input type="checkbox"/>	Carpet	- ten colours of the primary colour scheme	<input type="text"/>	sqm	6,-
<input type="checkbox"/>	Parquet floor	- decoration: oak, beech, walnut	<input type="text"/>	sqm	according to the type of parquets
<input type="checkbox"/>		- decoration: according to individual choice	<input type="text"/>	sqm	according to the type of parquets
<input type="checkbox"/>	Other materials	- stepping glass	<input type="text"/>	sqm	according to type
<input type="checkbox"/>		- slip-resistant plate	<input type="text"/>	sqm	according to type
<input type="checkbox"/>		- PVC flooring	<input type="text"/>	sqm	according to type

OTHER (PAGE 8.4)

Price in EUR without VAT

<input type="checkbox"/>	Speaker's desk (picture A)	<input type="text"/>	days	10,- /day
<input type="checkbox"/>	Chrome basket / deposit 2 000,- (picture B)	<input type="text"/>	days	10,- /day
<input type="checkbox"/>	Folding podium NIVTEC FLEXIBEL (picture C)	<input type="text"/>	sqm	24,- /sqm
<input type="checkbox"/>	Ceiling sheet (picture D)	<input type="text"/>	pc	4,- /pc
<input type="checkbox"/>	Point of suspension above the exposition on specified points in hall B	<input type="text"/>	pc	47,- / point
<input type="checkbox"/>	Display tools / grillage, hooks /			price determined upon agreement
<input type="checkbox"/>	Production of graphics - by printing and engraving			57,- / sqm
<input type="checkbox"/>	Complete delivery of a banner 15 x 1.8 m			1 563,-
<input type="checkbox"/>	Delivery of a canvas tent of type Röder			7,- / sqm
<input type="checkbox"/>	Building an assembled Veldeman hall			16,- / sqm

PLACE / DATE / STAMP / SIGNATURE



INCHEBA
EXPO BRATISLAVA

FURNITURE AND EQUIPMENT

FURNITURE

SEND THE FILLED-IN FORM VIA MAIL TO THE FOLLOWING ADDRESS:
INCHEBA, A.S. VIEDENSKÁ CESTA 3-7, 851 01 BRATISLAVA,
OR VIA FAX STATED ON THE REGISTRATION FORM

FIRM

EXHIBITION / FAIR

HALL

NAME OF THE RESPONSIBLE PERSON

TELEPHONE / EMAIL

TYPE (PAGE 8.6 - 8.7)	Number	Name	Dimension	Requirement	Price in EUR without VAT
CABINETS	1.	IKEA with roller curtain	80x45x65 cm	<input type="text"/>	pc 43,-
	2.	IKEA with shelves	80x34x81 cm	<input type="text"/>	pc 24,-
	3.	lockable cabinet	100x80x42 cm	<input type="text"/>	pc 38,-
	4.	cabinet with shelves	100x80x42 cm	<input type="text"/>	pc 29,-
TABLES	5.	KODRETA square	80x80x70 cm	<input type="text"/>	pc 11,-
	6.	GRAVIR	Ø 100 cm	<input type="text"/>	pc 13,-
	7.	KATA round	Ø 60 cm	<input type="text"/>	pc 9,-
	8.	round table	Ø 90cm	<input type="text"/>	pc 11,-
	9.	COFAX desk	100x63x73 cm	<input type="text"/>	pc 15,-
	10.	PROZE	120x80x75 cm	<input type="text"/>	pc 38,-
	11.	VIP table	120x60x57 cm	<input type="text"/>	pc 13,-
CHAIR	12.	DARINA chair		<input type="text"/>	pc 38,-
	13.	Leather chair		<input type="text"/>	pc 54,-
CHAIRS	14.	bar		<input type="text"/>	pc 24,-
	15.	IKEA chrome		<input type="text"/>	pc 5,-
	16.	IKEA white		<input type="text"/>	pc 8,-
	17.	IKEA plastic		<input type="text"/>	pc 4,-
	18.	Padded chair black, blue, green, red, grey		<input type="text"/>	pc 8,-
GARDEN FURNITURE	19.	PVC table		<input type="text"/>	pc 9,-
	20.	PVC chair		<input type="text"/>	pc 4,-
	21.	sunshade		<input type="text"/>	pc 11,-
MISCELLANEOUS	22.	safe-deposit	120x60x57 cm	<input type="text"/>	pc 10,-
	23.	stand hanger		<input type="text"/>	pc 8,-
	24.	refrigerator 225l		<input type="text"/>	pc 38,-
	25.	cooker table		<input type="text"/>	pc 5,-
	26.	hanger STANDER		<input type="text"/>	pc 13,-
	27.	stand for A4 leaflets		<input type="text"/>	pc 13,-
	28.	folding desk	height 99,5 cm	<input type="text"/>	pc 38,-
	29.	shelf A4 5 shelves	height 143 cm	<input type="text"/>	pc 32,-
	30.	BIG POLE flag stand	height 540 cm	<input type="text"/>	pc 47,-
	31.	FLY FLAG flag stand	height 350 cm	<input type="text"/>	pc 47,-
	32.	Wine refrigerator		<input type="text"/>	pc 44,-
	33.	Water stand		<input type="text"/>	pc 47,-
	34.	Stool water		<input type="text"/>	pc 7,-

PLACE / DATE / STAMP / SIGNATURE



INCHEBA
EXPO BRATISLAVA

FURNITURE AND EQUIPMENT

SMALL EQUIPMENT

SEND THE FILLED-IN FORM VIA MAIL TO THE FOLLOWING ADDRESS:
INCHEBA, A.S. VIEDENSKÁ CESTA 3-7, 851 01 BRATISLAVA,
OR VIA FAX STATED ON THE REGISTRATION FORM

FIRM	EXHIBITION / FAIR	HALL
<input type="text"/>		
NAME OF THE RESPONSIBLE PERSON	TELEPHONE / EMAIL	
<input type="text"/>		

Number	Name	Requirement	Price in EUR without VAT
1	Sugar bowl	<input type="text"/> pc	1,-
2	Tea-set (6pc)	<input type="text"/> pc	2,-
3	Cleansing articles	<input type="text"/> pc	1,-
4	Pot with lid	<input type="text"/> pc	4,-
5	Coffee maker/tea kettle	<input type="text"/> pc	1,-
6	Coffee maker ETA	<input type="text"/> pc	13,-
7	Coffee-set (6pc)	<input type="text"/> pc	2,-
8	Sugar-tongs	<input type="text"/> pc	1,-
9	Waste basket	<input type="text"/> pc	2,-
10	Mocca spoon – dessert set 6 pc	<input type="text"/> pc	1,-
11	Spoon soup set 6 pc	<input type="text"/> pc	3,-
12	Stewed fruit bowl	<input type="text"/> pc	1,-
13	Soap	<input type="text"/> pc	1,-
14	Ladle	<input type="text"/> pc	1,-
15	Dessert knife set 6 pc	<input type="text"/> pc	5,-
16	Kitchen knife	<input type="text"/> pc	1,-
17	Service knife set 6 pc	<input type="text"/> pc	6,-
18	Heater	<input type="text"/> pc	8,-
19	Can opener	<input type="text"/> pc	3,-
20	Teflon pan	<input type="text"/> pc	6,-
21	Stainless tray	<input type="text"/> pc	3,-
22	Glass Napoleon set 6 pc	<input type="text"/> pc	3,-
23	Glass Whisky 0.3l set 6 pc	<input type="text"/> pc	4,-
24	Glass 0.05l set 6 pc	<input type="text"/> pc	1,-
25	Glass 0.1l set 6 pcs	<input type="text"/> pc	1,-
26	Glass 0.2l set 6 pc	<input type="text"/> pc	3,-
27	Glass ashtray	<input type="text"/> pc	1,-
28	Table-napkin	<input type="text"/> pc	1,-
29	Salt-cellar	<input type="text"/> pc	1,-
30	Dessert plate	<input type="text"/> pc	1,-
31	Soup plate	<input type="text"/> pc	1,-
32	Main course plate	<input type="text"/> pc	1,-
33	Thermos flask	<input type="text"/> pc	6,-
34	Toilet paper	<input type="text"/> pc	1,-
35	Towel	<input type="text"/> pc	4,-
36	Dish-cloth	<input type="text"/> pc	1,-
37	Electric cooker	<input type="text"/> pc	13,-
38	Electric kettle	<input type="text"/> pc	10,-
39	Vase	<input type="text"/> pc	1,-
40	Bucket	<input type="text"/> pc	1,-
41	Fan	<input type="text"/> pc	2,-
42	Dessert fork set 6 pc	<input type="text"/> pc	3,-
43	Service fork set 6 pc	<input type="text"/> pc	3,-
44	Microwave oven	<input type="text"/> pc	32,-
45	White table-cloth	<input type="text"/> pc	5,-
46	Espresso coffee-maker	<input type="text"/> pc	32,-
47	Glass PVC (10pc)	<input type="text"/> pc	1,-

CONDITIONS FOR RENTING THE EQUIPMENT:

- A/ THE EXHIBITOR TAKES OVER AND RETURNS THE ORDERED EQUIPMENT PERSONALLY AT THE GIVING-OUT POINT OF SMALL EQUIPMENT ON THE EXHIBITION GROUNDS
B/ THE EQUIPMENT HAS TO BE RETURNED CLEAN AND IN THE ORIGINAL PACKING
C/ DAMAGE OR LOSS OF EQUIPMENT IS CHARGED AT THE ACQUISITION PRICE

PLACE / DATE / STAMP / SIGNATURE



INCHEBA
EXPO BRATISLAVA

FURNITURE AND EQUIPMENT FLOWERS

SEND THE FILLED-IN FORM VIA MAIL TO THE FOLLOWING ADDRESS:
INCHEBA, A.S. VIEDENSKÁ CESTA 3-7, 851 01 BRATISLAVA,
OR VIA FAX STATED ON THE REGISTRATION FORM

FIRM	EXHIBITION / FAIR	HALL
<input type="text"/>		
NAME OF THE RESPONSIBLE PERSON	TELEPHONE / EMAIL	
<input type="text"/>		

Number	Name	(page 8.8)	Requirement	Price in EUR without VAT
48	JARDINIERE LIVE ARRANGEMENT		<input type="text"/> pc	26,-
49	BIG FLOWER BOWL		<input type="text"/> pc	60,-
50	SMALL FLOWER BOWL		<input type="text"/> pc	46,-
51	JARDINIERE EVA		<input type="text"/> pc	32,-
52	IKEBANA		<input type="text"/> pc	24,-
53	CUT FLOWERS		<input type="text"/> pc	individual
54	FLOWERS, flower planting according to individual choice		<input type="text"/> pc	individual
55	ARTIFICIAL FLOWER	high	<input type="text"/> pc	14,
		low	<input type="text"/> pc	6,-
		climbing	<input type="text"/> pc	4,-
56	DRY ARRANGEMENT		<input type="text"/> pc	26,-

PLACE / DATE / STAMP / SIGNATURE



INCHEBA
EXPO BRATISLAVA

AUDIOVISUAL TECHNIQUE

SEND THE FILLED-IN FORM VIA MAIL TO THE FOLLOWING ADDRESS:
INCHEBA, A.S. VIEDENSKÁ CESTA 3-7, 851 01 BRATISLAVA,
OR VIA FAX STATED ON THE REGISTRATION FORM

FIRM

EXHIBITION / FAIR

HALL

NAME OF THE RESPONSIBLE PERSON

TELEPHONE / EMAIL

Presentation technique for rent

required number of pieces / number of days

Price in EUR without VAT

Data-video-projector 1500 ansi	<input type="text"/>	94,-
Data-video-projector 2500 ansi	<input type="text"/>	125,-
Data-video-projector 4100 ansi (built-in in EXPO CLUB)	<input type="text"/>	219,-
Data-video-projector 4100 ansi (built-in in the Conference hall)	<input type="text"/>	282,-
Projection screen on tripod 160x160 cm	<input type="text"/>	25,-
Projection screen on tripod 240x180 cm	<input type="text"/>	38,-
Projection screen in frame 320x210 cm	<input type="text"/>	94,-
Projection screen in frame 427x320 cm	<input type="text"/>	141,-
Plasma display diagonal 42" (107cm)	<input type="text"/>	150,-
Plasma display diagonal 50" (127cm)	<input type="text"/>	266,-
Plasma display diagonal 60" (150cm)	<input type="text"/>	469,-
LCD display diagonal 17" or 19" (43; 48 cm)	<input type="text"/>	38,-
LCD display diagonal 32" (81 cm)	<input type="text"/>	125,-
LCD display diagonal 42" (107 cm)	<input type="text"/>	282,-
Television diagonal 21 (55 cm)	<input type="text"/>	25,-
Camcorder mini DV with tripod	<input type="text"/>	47,-
DVD player or VHS player	<input type="text"/>	25,-
Notebook (XP Professional, MS Office, 512 MB RAM, DVD-drive)	<input type="text"/>	94,-
Flipchart (board for writing)	<input type="text"/>	13,-
Portable sound system 200W (2x speaker, amplifier, mix-desk, 1x wired microphone)	<input type="text"/>	63,-
Portable sound system 600W (2x speaker, amplifier, mix-desk, 1x wired microphone)	<input type="text"/>	94,-
Wireless microphone (hand or head)	<input type="text"/>	29,-
Interpretation installation for 1 channel and small cabin	<input type="text"/>	110,-
Small interpretation subscriber station	<input type="text"/>	2,-
Large interpretation cabin	<input type="text"/>	122,-
Technical service	<input type="text"/>	79,-

If other technique is required the price will be agreed upon.

PLACE / DATE / STAMP / SIGNATURE



INCHEBA
EXPO BRATISLAVA

TECHNICAL SUPPLIES

ELECTRICITY, WATER, COMPRESSED AIR

SEND THE FILLED-IN FORM VIA MAIL TO THE FOLLOWING ADDRESS:
INCHEBA, A.S. VIEDENSKÁ CESTA 3-7, 851 01 BRATISLAVA,
OR VIA FAX STATED ON THE REGISTRATION FORM

FIRM

EXHIBITION / FAIR

HALL

NAME OF THE RESPONSIBLE PERSON

TELEPHONE / EMAIL

ELECTRICITY

 230 V

 400 V

Requirement

Price in EUR without VAT

to 2 kW

sink – hot water	2,0 kW/h
spot light	0,1 kW/h
drop light	0,1 kW/h
refrigerator	0,3 kW/h
TV, video	0,3 kW/h
coffee maker	1,0 kW/h
cooker	2,2 kW/h

 pc

141,-

to 3 kW

 pc

204,-

to 5 kW

 pc

297,-

to 10 kW

 pc

485,-

to 15 kW

 pc

579,-

to 20 kW

 pc

704,-

independent refrigerator circuit

 pc

35,-

WATER

Price in EUR without VAT

water supply to own sink

 pc

211,-

water supply to rented sink

 pc

266,-

COMPRESSED AIR

Price in EUR without VAT

supply of compressed air

 pc

313,-

PLACE / DATE / STAMP / SIGNATURE



INCHEBA
EXPO BRATISLAVA

TELECOMMUNICATION SERVICES

TELEPHONE LINES, ISDN, INTERNET

SEND THE FILLED-IN FORM VIA MAIL TO THE FOLLOWING ADDRESS:
INCHEBA, A.S. VIEDENSKÁ CESTA 3-7, 851 01 BRATISLAVA,
OR VIA FAX STATED ON THE REGISTRATION FORM

FIRM	EXHIBITION / FAIR	HALL
<input type="text"/>		
NAME OF THE RESPONSIBLE PERSON	TELEPHONE / EMAIL	
<input type="text"/>		

TELEPHONE

Price in EUR without VAT

<input type="checkbox"/>	CONNECTION OF TELEPHONE LINE	24,-
<input type="checkbox"/>	TELEPHONE CALLS	63,-

INTERNET

Price in EUR without VAT

<input type="checkbox"/>	CONNECTION TYPE A HOT SPOT internet (wifi)	1h 3h 24h	4,- 7,- 18,-
<input type="checkbox"/>	CONNECTION TYPE B Connection of a single computer to the internet through an analogue dial up line with the transmission speed 56 kbps at maximum. The exhibitor uses his own modem, program equipment and internet registration. Telephone charge will be charged separately. Supplementary service rent of external modem establishment of an internet account for the duration of the exhibition		104,- 16,- 8,-
<input type="checkbox"/>	CONNECTION TYPE C Connection of a single computer to the internet through ISDN with the transmission speed 128 kbps. The exhibitor uses his own modem, program equipment and internet registration. Telephone charge will be charged separately. Supplementary service rent of external modem establishment of an internet account for the duration of the exhibition		188,- 22,- 18,-
<input type="checkbox"/>	CONNECTION TYPE D Connection of a single computer to the internet through a network connection – connector RJ 45 with the transmission speed 256 kbps. The price of the service includes the installation costs, the operation of a telephone line and the necessary network components. NOT POSSIBLE FOR ASSEMBLED HALL E.		219,-
<input type="checkbox"/>	CONNECTION TYPE E Connection of a computer network or a single computer to the internet through a network connection – connector RJ 45 with the transmission speed 512 kbps. The price of the service includes the installation costs, the operation of a telephone line and the necessary network components. NOT POSSIBLE FOR ASSEMBLED HALL E.		329,-
<input type="checkbox"/>	CONNECTION TYPE F Connection of a computer network to the internet through a network connection – connector RJ 45 with the transmission speed 1024 kbps. The price of the service includes the installation costs, the operation of a telephone line and the necessary network components. NOT POSSIBLE FOR ASSEMBLED HALL E.		485,-
<input type="checkbox"/>	CONNECTION TYPE G Connection of a computer network to the internet through a network connection – connector RJ 45 with the transmission speed 2048 kbps. The price of the service includes the installation costs, the operation of a telephone line and the necessary network components. NOT POSSIBLE FOR ASSEMBLED HALL E.		610,-

PLACE / DATE / STAMP / SIGNATURE



INCHEBA
EXPO BRATISLAVA

SERVICES

SEND THE FILLED-IN FORM VIA MAIL TO THE FOLLOWING ADDRESS:
INCHEBA, A.S. VIEDENSKÁ CESTA 3-7, 851 01 BRATISLAVA,
OR VIA FAX STATED ON THE REGISTRATION FORM

CLEANING, GUARDING, HOSTESSES, INTERPRETING

FIRM

EXHIBITION / FAIR

HALL

NAME OF THE RESPONSIBLE PERSON

TELEPHONE / EMAIL

CLEANING

REQUIREMENT

Price in EUR without VAT

CLEANING

sqm

1,- /sqm/day

GENERAL CLEANING

of the exposition not realised by Incheba a.s. after termination of assembly

sqm

2,- /sqm

GUARDING

Price in EUR without VAT

GUARDING OF THE EXPOSITION

persons

7,- / h

HOSTESSES

Price in EUR without VAT

WITHOUT KNOWLEDGE OF A FOREIGN LANGUAGE

persons

6,- /h

WITH KNOWLEDGE OF A FOREIGN LANGUAGE

persons

8,- /h

INTERPRETER

Price in EUR without VAT

WITH KNOWLEDGE OF A FOREIGN LANGUAGE

persons

47,- /h

PLACE / DATE / STAMP / SIGNATURE



INCHEBA
EXPO BRATISLAVA

SEND THE FILLED-IN FORM VIA MAIL TO THE FOLLOWING ADDRESS:
INCHEBA, A.S. VIEDENSKÁ CESTA 3-7, 851 01 BRATISLAVA,
OR VIA FAX STATED ON THE REGISTRATION FORM

FIRM

EXHIBITION / FAIR

HALL

NAME OF THE RESPONSIBLE PERSON

TELEPHONE / EMAIL

PASSES

Price in EUR without VAT

EXHIBITION PASSES

16,- /pc

Number of required passes: free of charge pc paid (additional order) pc in total pc

The exhibition pass authorises entry onto the premises during assembly, disassembly and during the exhibition one hour before the opening of the exhibition and one hour after termination of the exhibition.

The entitlement of the exhibitors for free passes according to the size of the area: 0 – 19 sqm – 3pc, 19 – 49 sqm – 5pc, 50 – 99 sqm – 7pc, 100 – 199 sqm – 10pc, over 200 sqm – 1pc for each 20 sqm. If the exhibition passes were not paid by invoice, they can be purchased at the registration desk in cash.

Co-exhibitors can receive free exhibition passes only through their main exhibitor. Therefore it depends on the agreement of the main exhibitor with his co-exhibitors how the number of the free exhibition passes will be divided.

ASSEMBLY PASSES

32,- /pc (not valid for CONECO)

Number of required passes: paid (additional order) pc in total pc

Assembly passes are designed for individual workers of construction firms and suppliers. Without these passes they will not be allowed to enter onto the premises of Incheba a.s. during assembly and disassembly of the exhibition.

VALID ONLY FOR CONECO

Assembly fee for sqm of realised construction

7,- /sqm

The price includes: the assembly pass / assembly current / current cleaning during assembly and disassembly / assembly lighting of halls / assembly tempering of halls / work place outside the hall rough adjustment of the stand elements

PARKING PASSES

exhibition event 1-3 days
exhibition event 4-6 days
CONECO

32,- /pc
47,- /pc
79,- /pc

Number of required passes: in total pc

The parking pass authorises parking within the premises of the exhibition grounds, on a parking area reserved for exhibitors. Access to the parking area is through the access gate below Nový most. If the parking passes were not paid by invoice, they can be purchased at the registration desk in cash. The parking passes are valid during assembly, duration and disassembly of the event. If you have not purchased a parking pass entry onto the premises with a car is possible only after payment of the parking fee.

INVITATIONS

required number pc

EXHIBITORS CATALOGUE

required number pc

PLACE / DATE / STAMP / SIGNATURE



INCHEBA
EXPO BRATISLAVA

SEND THE FILLED-IN FORM VIA MAIL TO THE FOLLOWING ADDRESS:
INCHEBA, A.S. VIEDENSKÁ CESTA 3-7, 851 01 BRATISLAVA,
OR VIA FAX STATED ON THE REGISTRATION FORM

FIRM

EXHIBITION / FAIR

HALL

NAME OF THE RESPONSIBLE PERSON

TELEPHONE / EMAIL

LOADING AND UNLOADING

Price in EUR without VAT

Unloading on at hoursLoading on at hours

1. Complete deliveries	to 3000 kg	7,- / 100 kg	19,- / delivery at minimum
	over 3001 kg	5,- / 100 kg	
2. Collecting deliveries	to 300 kg	10,- / 100 kg	29,- / delivery at minimum
	over 300 kg	11,- / 100 kg	

The price includes the costs from the incoming truck to the placement next to the stand (or at the closest accessible point). The rates will be invoiced even if the exhibitor realises or assists during the loading (unloading), if our means of mechanization are used.

STORING

Price in EUR without VAT

<input type="checkbox"/>	Storing of deliveries	Storage fee	5,- / sqm / day
<input type="checkbox"/>	Storing of empty packages of approximately <input type="text"/> m ³	Storage fee	16,- / 100 kg
	If the weight of the packages is not mentioned in the document, 1/3 of the gross weight of the delivery is charged.		16,-/delivery

FACILITIES

Price in EUR without VAT

<input type="checkbox"/>	Work force	7,- / hour	<input type="checkbox"/>	Ladder	individual price
<input type="checkbox"/>	Hand pallet truck (only with workers of forwarding services)	13,- / hour	<input type="checkbox"/>	Hydraulic platform	individual price
<input type="checkbox"/>	Fork lift (only for assembly)	25,- / hour	<input type="checkbox"/>	Work truck	8,- /hour
<input type="checkbox"/>	Crane	75,- / hour	<input type="checkbox"/>	Mobile scaffolding	individual price

TRANSPORT OF DELIVERIES

Price in EUR without VAT

<input type="checkbox"/>	Transport to the exhibition or from the exhibition	individual
<input type="checkbox"/>	Clearance of deliveries arriving from abroad	individual
<input type="checkbox"/>	From the warehouse or to the warehouse in Bratislava, including loading and unloading	25,- / 100 kg
		38,-/ delivery at minimum

ADDITIONAL CHARGES

Heavy pieces	500 to 3000 kg	25%
	3001 to 10 000 kg	50 %
	10001 and more kg	100 %
Unpacked goods		50%
Late arrival	one day before the opening of the fair	100%
	1st day of the opening of the fair	150%

The payment has to be realised immediately in cash.

We notify our clients that the fair premises of Incheba a.s. are a customs territory and mechanized manipulation with material may be carried out only by Incheba a.s.

PLACE / DATE / STAMP / SIGNATURE



INCHEBA
EXPO BRATISLAVA

SEND THE FILLED-IN FORM VIA MAIL TO THE FOLLOWING ADDRESS:
INCHEBA, A.S. VIEDENSKÁ CESTA 3-7, 851 01 BRATISLAVA,
OR VIA FAX STATED ON THE REGISTRATION FORM

FIRM	EXHIBITION / FAIR	HALL
<input type="text"/>		
NAME OF THE RESPONSIBLE PERSON	TELEPHONE / EMAIL	
<input type="text"/>		

LEASE OF PREMISES

Price in EUR without VAT / 1 hour

- | | | |
|--------------------------|---|-------|
| <input type="checkbox"/> | Expo club, Conference hall during exhibition events Coneco for exhibitors | 157,- |
| <input type="checkbox"/> | Expo club, Conference hall during exhibition events Coneco for non-exhibitors | 469,- |
| <input type="checkbox"/> | Expo club, Conference hall during other exhibition events for exhibitors | 94,- |
| <input type="checkbox"/> | Expo club, Conference hall during other exhibition events for non-exhibitors | 282,- |

The price of rent includes heating/ventilation during the event, general lighting.

Expo club / cinema-seating capacity up to 140 persons / school-seating capacity up to 72 persons

Conference hall / cinema-seating capacity up to 288 persons

TECHNIQUE (projection, sound, interpretation technique)

Price in EUR without VAT / 1 hour

Price in EUR without VAT / 4 hours and more

- | | | | |
|--------------------------|---|-------|-------|
| <input type="checkbox"/> | Data-video-projector 4100 ansi (built-in in Expo club) | 60,- | 219,- |
| <input type="checkbox"/> | Data-video-projector 5000 ansi (built-in in the Conference hall) | 75,- | 282,- |
| <input type="checkbox"/> | Projection screen 2.4x1.8m (built-in in Expo club) | 11,- | 38,- |
| <input type="checkbox"/> | Projection screen 4x3m (built-in in the Conference hall) | 8,- | 141,- |
| <input type="checkbox"/> | Sound system of the premises – Expo club, 1x wired microphone | 19,- | 63,- |
| <input type="checkbox"/> | Sound system of the premises – Conference hall, 1x wired microphone | 29,- | 94,- |
| <input type="checkbox"/> | Wireless microphone (hand or head) | 10,- | 29,- |
| <input type="checkbox"/> | Interpretation installation for 1 channel and small cabin | 110,- | 110,- |
| <input type="checkbox"/> | Small interpretation subscriber station | 2,- | 2,- |
| <input type="checkbox"/> | Large interpretation cabin | 122,- | 122,- |
| <input type="checkbox"/> | Technical service | 22,- | 79,- |

TECHNICAL CONSTRUCTION

Price in EUR without VAT

- | | | | |
|--------------------------|---|----------------------|----|
| <input type="checkbox"/> | Self-standing board for posting logos, sticking posters | <input type="text"/> | pc |
|--------------------------|---|----------------------|----|

PLACE / DATE / STAMP / SIGNATURE



INCHEBA
EXPO BRATISLAVA

SEND THE FILLED-IN FORM VIA MAIL TO THE FOLLOWING ADDRESS:
INCHEBA, A.S. VIEDENSKÁ CESTA 3-7, 851 01 BRATISLAVA,
OR VIA FAX STATED ON THE REGISTRATION FORM

FIRM

EXHIBITION / FAIR

HALL

--	--	--

NAME OF THE RESPONSIBLE PERSON

TELEPHONE / EMAIL

--	--

CO-EXHIBITOR 1

Firm / Name of the responsible person

Street, number

State, Post code, City

Telephone

Fax

E-mail

CO-EXHIBITOR 2

Firm / Name of the responsible person

Street, number

State, Post code, City

Telephone

Fax

E-mail

PLACE / DATE / STAMP / SIGNATURE



INCHEBA
EXPO BRATISLAVA

SEND THE FILLED-IN FORM VIA MAIL TO THE FOLLOWING ADDRESS:
INCHEBA, A.S. VIEDENSKÁ CESTA 3-7, 851 01 BRATISLAVA,
OR VIA FAX STATED ON THE REGISTRATION FORM

FIRM

EXHIBITION / FAIR

HALL

--	--

NAME OF THE RESPONSIBLE PERSON

TELEPHONE / EMAIL

--	--

CONSTRUCTION OF EXPOSITION

Firm

--

Street, number

State, Post code, City

--

--

Telephone

Fax

E-mail

--

--

--

DECORATION OF EXPOSITION

Firm

--

Street, number

State, Post code, City

--

--

Telephone

Fax

E-mail

--

--

--

PLACE / DATE / STAMP / SIGNATURE



INCHEBA
EXPO BRATISLAVA

TYPE STANDS INTERIOR – 2.1

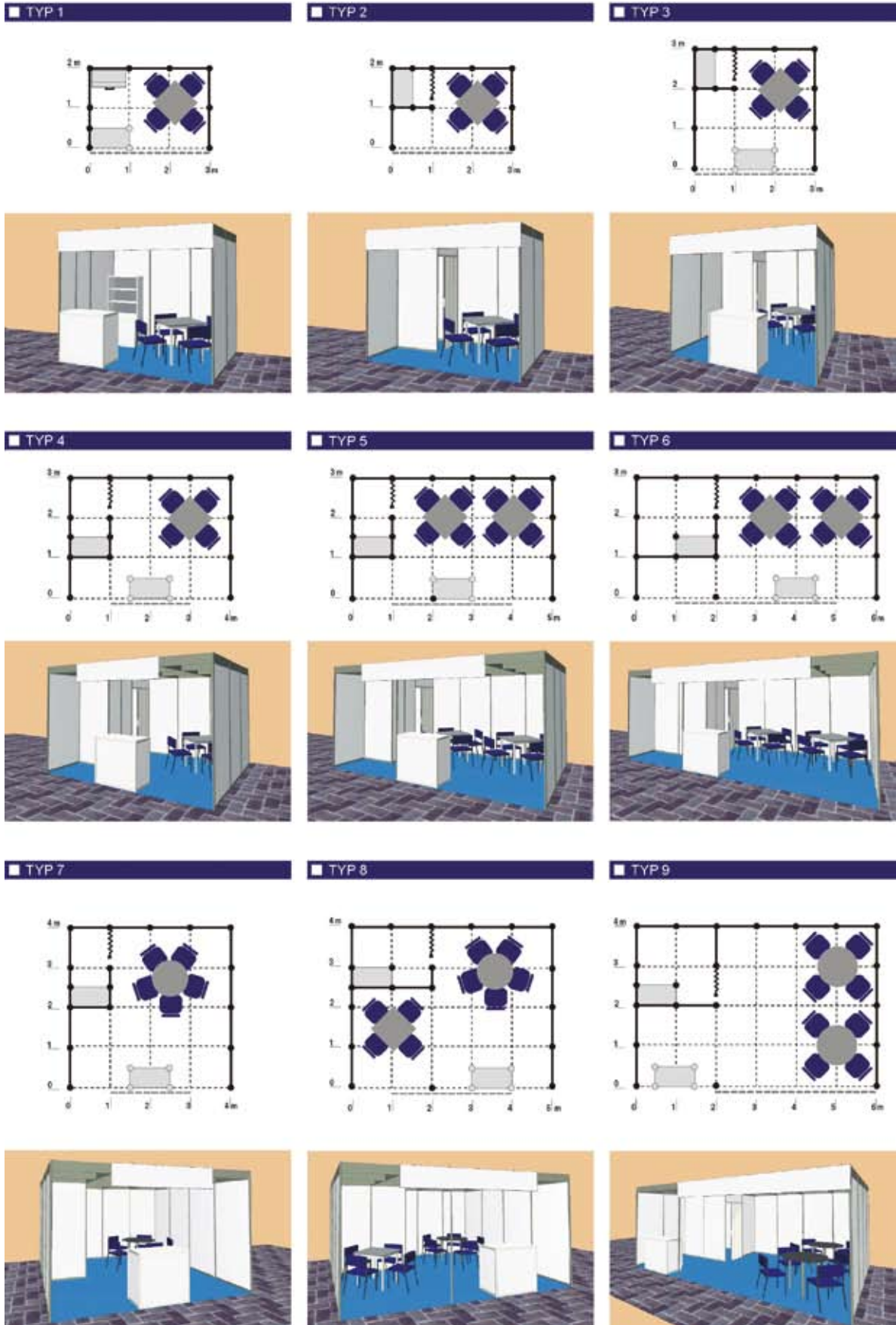

TYP 10

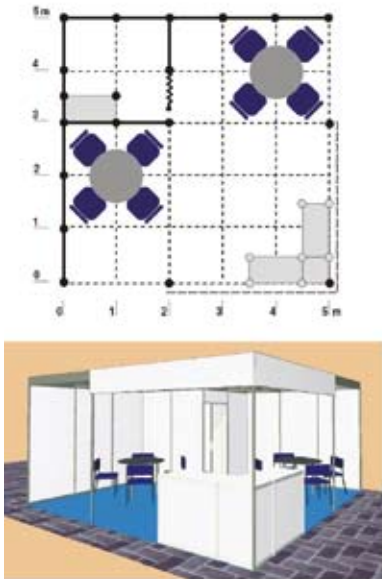

FLOOR / 2.3

CARPET :

COLOR SCHEME



COLOUR ACCORDING TO INDIVIDUAL CHOICE (ANOTHER 25 SHADES)

OTHER MATERIALS

ACCORDING TO INDIVIDUAL CHOICE (STEPPING GLASS, AL-SLIP-RESISTANT PLATE, PVC)

PARQUETS / LAMINATE

DECORATION



DECORATION ACCORDING TO INDIVIDUAL CHOICE (ANOTHER 6 DECORATIONS)

TYPE STANDS EXTERIOR / 2.1

TYP 1

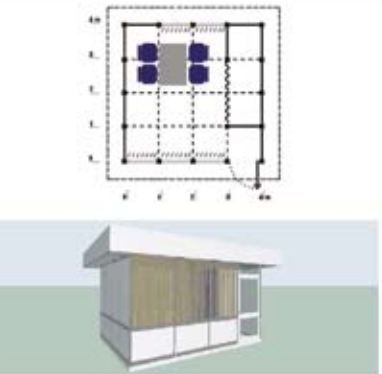

TYP 2

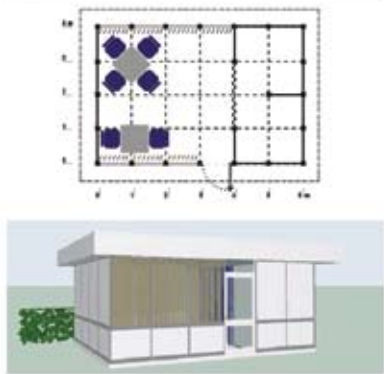

TYP 3

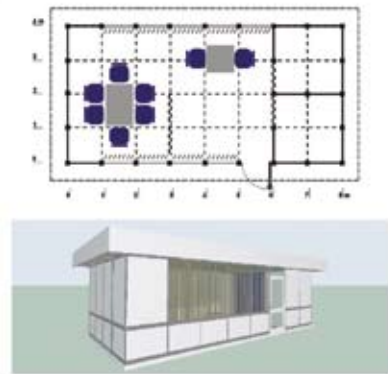

TYP 4

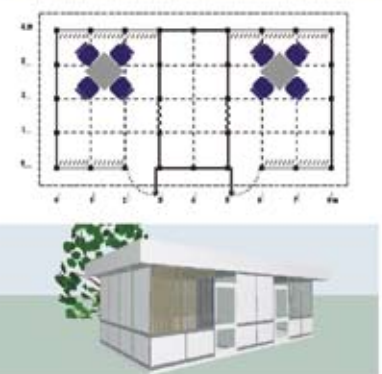

TYP 5

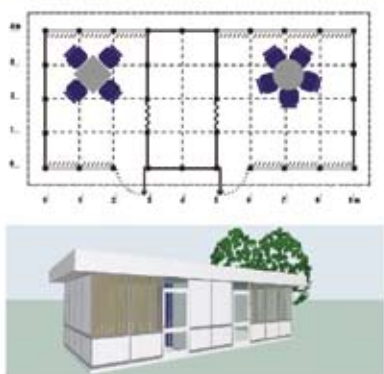

LEGENDA

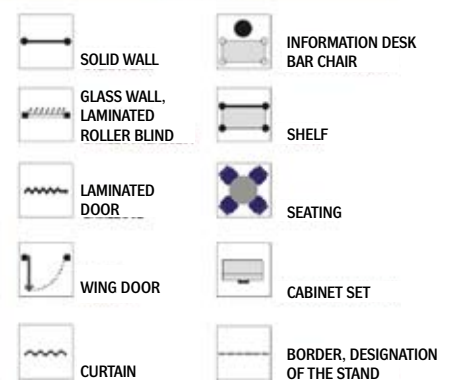

INDIVIDUALLY DESIGNED STANDS / 2.1

■ ATTACHED STAND 6 sqm



■ TWO SIDES OPEN 50 sqm



■ THREE SIDES OPEN 52 sqm



■ FOUR SIDES OPEN 100 sqm



■ FLOOR STAND

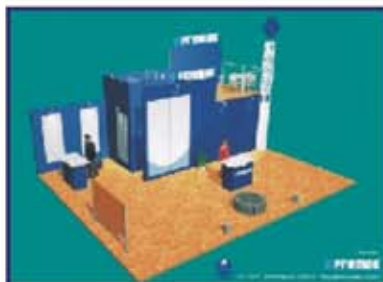

TYPE ELEMENTS / 2.2

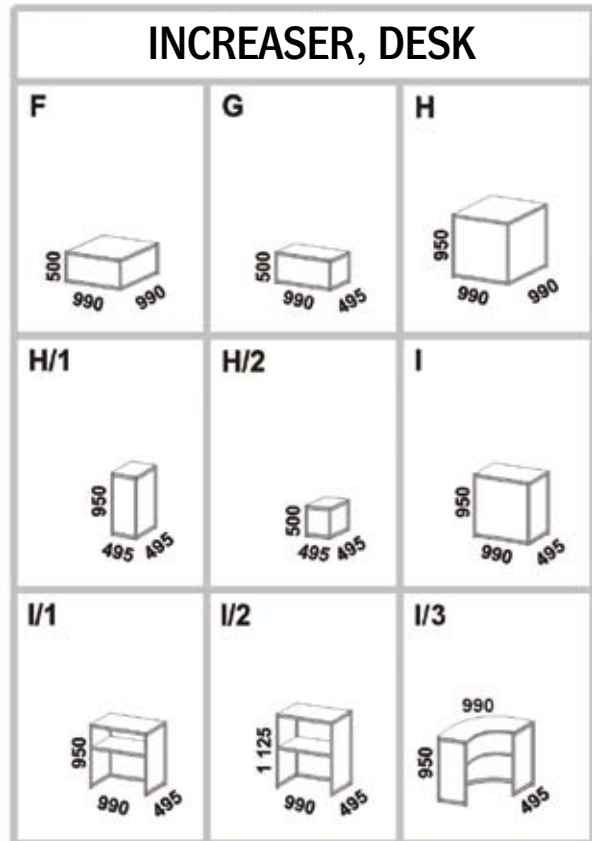
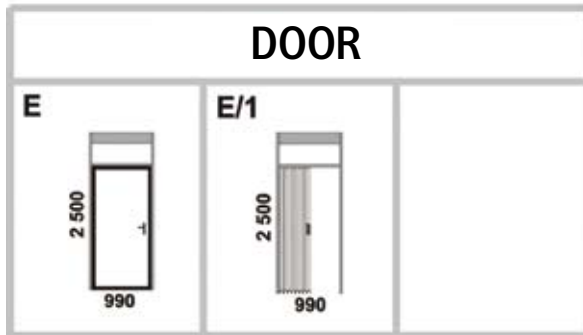
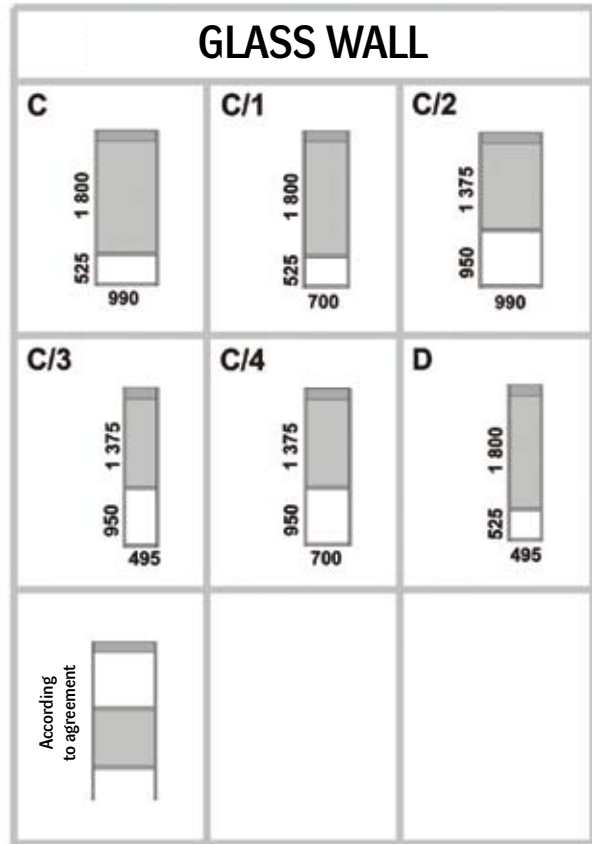
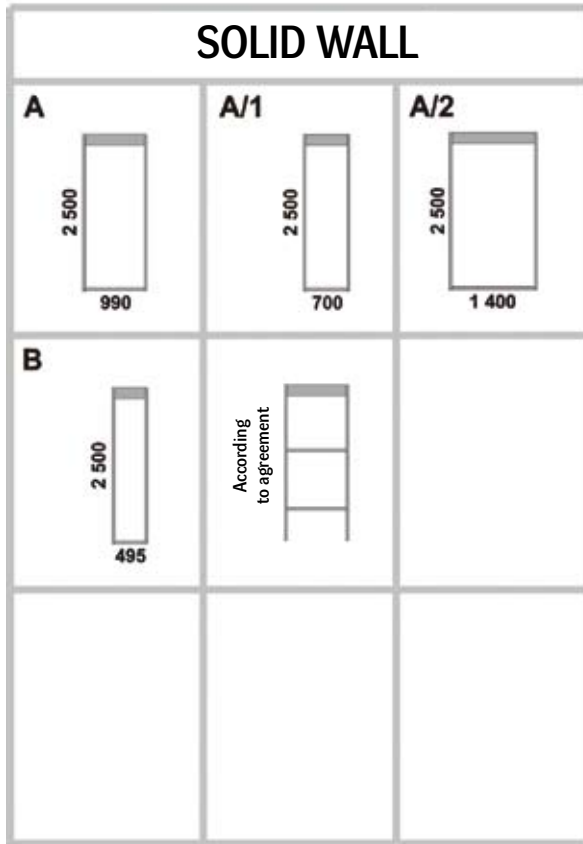

OTHER / 2.3

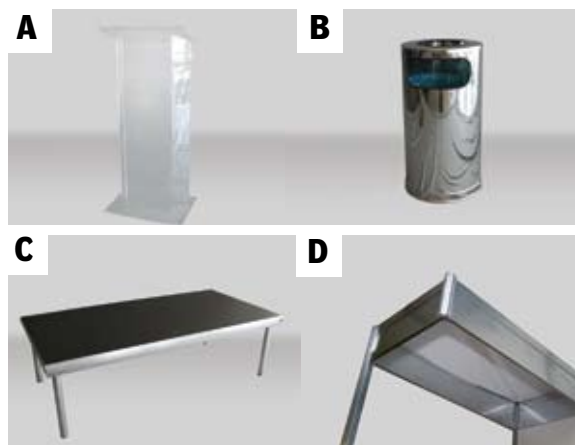

TYPE ELEMENTS / 2.2

SHOW-CASE

J 	J/1 	K
K/1 	K/2 	According to agreement
L 	M 	M/1

SHOW-CASE

K/3 		
SHOW-CASE TYPE TRA (limited number)		
According to agreement		

SHELF, CURTAIN, ROLLER BLINDS

N According to agreement 	O (Horizontal shelves) According to agreement 	OŠ (Inclined shelves) According to agreement
P According to agreement 	P/1 	S CURTAIN
Y ROLLER BLINDS 		

ACCESSORIES

R SIGN 	
V BORDER 	
Z CUBE 	

FURNITURE / 3.1

1



2



3



4



5



6



7



8



9



10



11



11



12



13



14



15



16



17



18



19



FURNITURE / 3.1

20



21



22



23



24



25



26



27



28



29



30



31



32



33



FLOWERS / 3.3

49



50



51



53



54



54



55



55



56

